

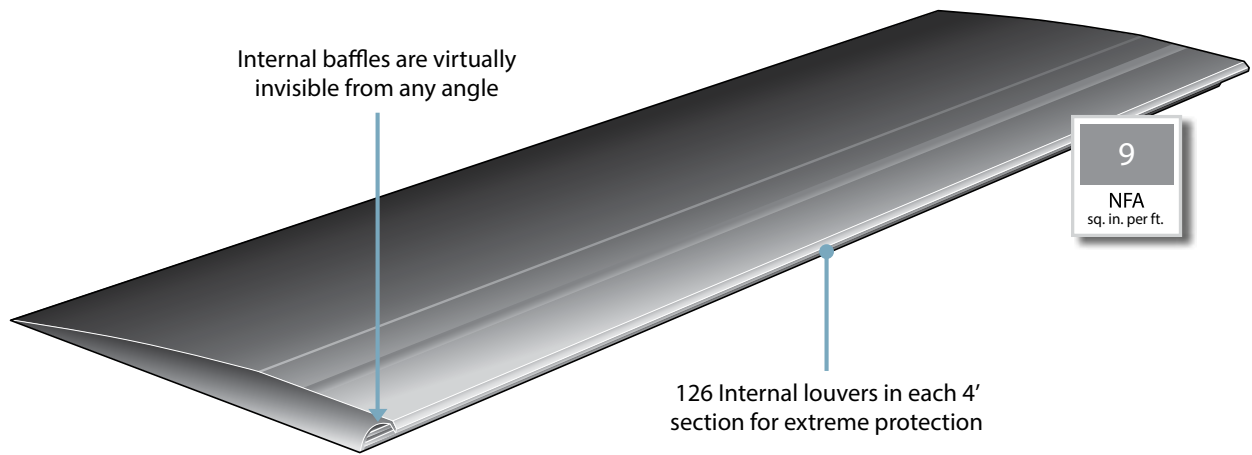

HIGH POINT[®]

INTAKE



Features

- Fits pitches 3:12 to 16:12
- NFA: 9
- Our speciality formulated polymer creates a stronger product than competition
- Provides intake ventilation for homes with no overhang
- Low profile. Blends with roof construction
- Preformed nail holes
- Flexible and easy installation
- Firm and pliable design ensures and maintains proper orientation of baffle
- No connectors, straps or gaskets
- Self sealing ends
- Interior baffles and louvers for proven protection
- Prevents rain, snow and insect infestation
- Exceeds Department of Energy recommendations and all nationally recognized building codes when installed properly

Options

- Part Only



Install the Complete System and Maximize the Coverage

- 1 Atlas WeatherMaster[®] Ice & Water Underlayment
- 2 Atlas Premium Underlayment
- 3 Atlas Pro-Cut[®] Starter Shingles
- 4 Atlas Roof Shingles
- 5 Atlas TruRidge[®] & HighPoint[®] Exhaust Ventilation
- 6 Atlas Pro-Cut[®] Hip & Ridge Shingles



*Refer to the Atlas Signature Select[®] Limited Warranty for all system coverage requirements.

HIGHPOINT® INTAKE INSTALLATION INSTRUCTIONS

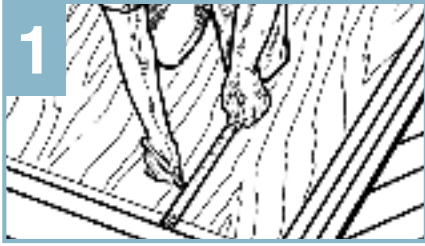

1 Remove all roofing materials for reroof applications. Install edge flashing and gutter straps as necessary. Measure 5" from edge flashing and bend to mark lower slot line. Measure 3/4" further up to mark upper slot line.

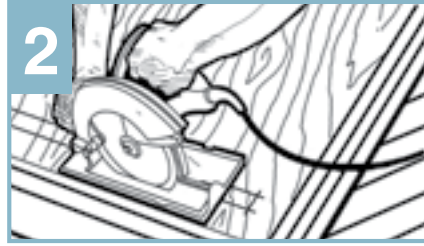

2 Cut slot with circular saw. **Warning:** Adjust depth of blade to avoid cutting rafters or trusses. Refer to drawings below for slot dimensions. Remove debris from slot.

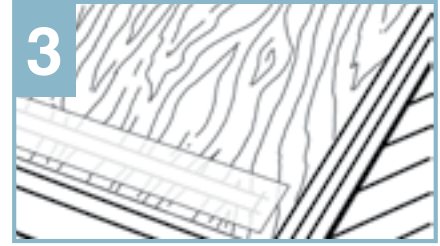

3 Install code approved shingle underlayment onto the bare deck 10 1/2" from the edge of the roof up the slope.



4 Making sure the slot is open from step #3 position the intake vent over the slot opening insuring that the rear edge of the interior baffles are placed ahead of the slot opening. Start at the end of the roof aligning the vent flush with the end and install continuously until entire length is covered.



5 Use utility knife to cut final section to length. Integrated end plug of final section should be flush with end of roof. Pre-fasten final section.



6 Install code approved shingle underlayment over the intake vent being careful to avoid mailing into the roof deck slot. Using a chalk line, transfer the mail line (2 5/8" from drip edge) and slot location (5 3/4" to 7" from drip edge) to the top of the felt or waterproofing shingle underlayment.



7 Install starter and first course shingles over shingle underlayment. Cover the intake vent using shingle manufacturer guidelines for shingle overhang and nailing requirements. Nailing patterns may have to deviate from some shingle installation instructions to avoid nailing into the slot location.

INSTRUCTIONS FOR CUTTING SLOTS:

Hip & Gable Roofs
Cut 3/4" slot 5" up from drip edge. Terminate slot 6" inside of end walls and 12" from hip ridges.

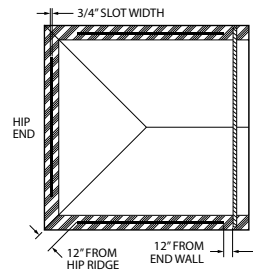

Roofs with Valleys
Cut 3/4" slot 5" up from drip edge. Terminate slot 6" inside of end walls and at least 12" from valleys.

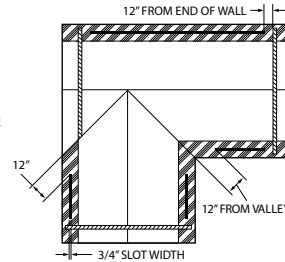

Chimneys
Cut 3/4" slot 5" up from drip edge. Terminate slot 12" up from chimneys that penetrate the roof.

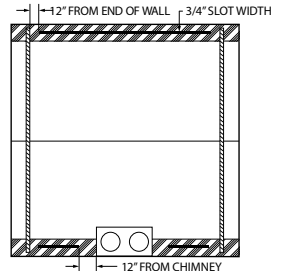

Technical Specs

9 NFA sq. in. per ft.	48" PC LENGTH	12 CARTON/PALLET
44 LINEAR FEET/CARTON	11 PC/CARTON	

UNIFORM BUILDING CODES

R806.2 Minimum area. The total net free ventilating area shall not be less than 1/150 of the area of the space ventilated except that the total area is permitted to be reduced to 1/300, provided at least 40 percent and not more than 50 percent of the required ventilating area is provided by ventilators located in the upper portion of the attic or rafter space. Upper ventilators shall be located not more than 3 feet (914 mm) below the ridge or highest point of space, measured vertically, with the balance of the required ventilation provided by the eave or cornice vents. See the published International Residential Code for additional information.

Application and installation procedures are beyond the control of the seller or manufacturer. (Consequently, neither party shall be responsible for failure of the product when not used in strict accordance to instructions and specifications.)

#AtlasProtects

AtlasRoofing.com

